

## PRESS-FORGED CONTROL VALVES IN BRASS-58

### In line double-acting needle control valves (Female/Female)

For use with pressures up to 210 bar.

They allow for regulation of flow in both directions  
Suitable for applications with air, gas and liquid in general.  
As an alternative to FT 257/2 where the working pressure does not exceed 210 bar and when ferrous materials cannot be used.

Same basic characteristics as the FT 257 series:

- accurate flow regulation;
- efficient metallic sealing;
- simple setting of flow rates;
- secure against accidental needle withdrawal;
- secure needle position with locking screw inserted in the handwheel;
- provisions for panel mounting, for which special lock nut (G) is supplied on request.

#### On request

- Versions in stainless steel AISI 316 code FT 2251/2-01
- Viton seals (V)
- NPT threads
- Handwheel in ABS (mp) plastic
- Complete with lock nut (G)

### MATERIALS

Body	OT 58 - UNI 5705 - Nickel plated
Needle	X 10 Cr Ni S 1809 - UNI 6900
Or	Nitrile
Antiextrusion ring	PTFE
Handwheel ma	GD - Al Si 12
	UNI 5706 aluminium
Handwheel mp	ABS plastic

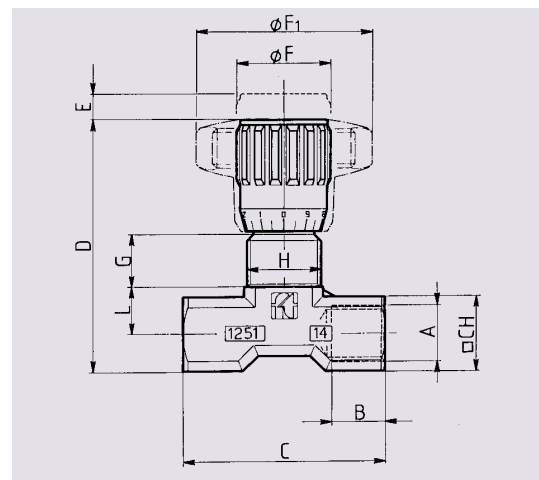

### EXAMPLE FOR ORDERING

CODE  
FT 1251/2-01

#### Accessories on request

	Code	Type	Lock nut	Viton seal	Handwheel ABS plastic
Brass	FT 1251/2-01	38	G	V	mp
Stainl. steel	FT 2251/2-01	14	G	V	mp

Type	A	B	C	D	E	F	F1	G	H	L	CH	Weight kg
UNI 338												
18	1/8"G	8	40	55	4	22	40	12	M15x1	9.5	15	0.105
14	1/4"G	12	46	57	4.5	22	40	11.5	M17x1	11	17	0.122
38	3/8"G	13	55	69	7	27	50	12.5	M20x1	15	22	0.233
12	1/2"G	16	70	82	10	33	70	13	M25x1.5	19	27	0.455
34	3/4"G	20	91	100	12	38	80	15	M30x1.5	22	34	0.860

Note: Instructions for panel mounting on page 86



HOME



INTRODUCTION



VALVES INDEX



LAST VIEW



PRINT