



## IN LINE NEEDLE VALVES CHECK VALVES IN CARBON STEEL

### In line double-acting flow control and shut-off control needle valves

They allow flow control in both directions. Needle adjustments give:

- full shut off (via metal seat);
- accurate control for a wide range of flowrates.

The valve has a graduated adjustment scale below the handle to indicate accurately the valve position.

There is a locking screw in the handle to allow the handle to be fixed. (Preventing accidental adjustment or movement due to vibration).

A panel mounting nut (G) can be supplied on request.

#### On request

- Versions in AISI 316 stainless steel code FT 2257/2
- Viton seals (V)
- NPT threads
- Complete with panel mounting nut (G)
- Handwheel in ABS (mp) - plastic

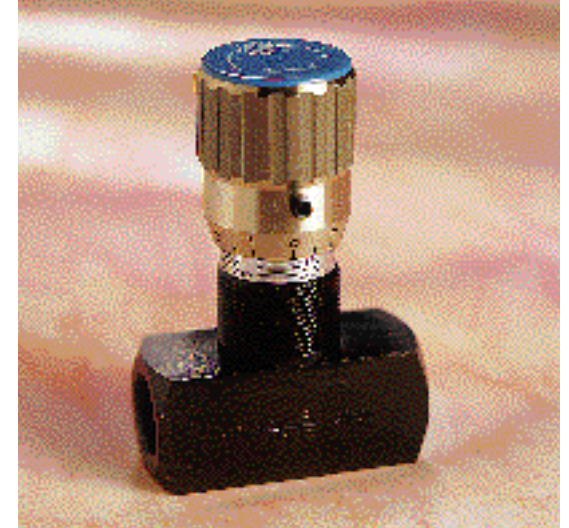

### MATERIALS

Body	9 s Mn Pb 23 - UNI 5105
Needle	1 C 40 - UNI 8373
Or	Nitrile
Antiextrusion ring	PTFE
Handwheel	GD - Al Si 12 - UNI 5706 aluminium
Handwheel (mp)	ABS - plastic

### EXAMPLE FOR ORDERING

Accessories on request					
	Code	Type	Panel ring	Viton seal	Handwheel in plastic
Steel	FT 257/2	18	G	V	mp
Stainl. steel	FT 2257/2	38	G	-	mp

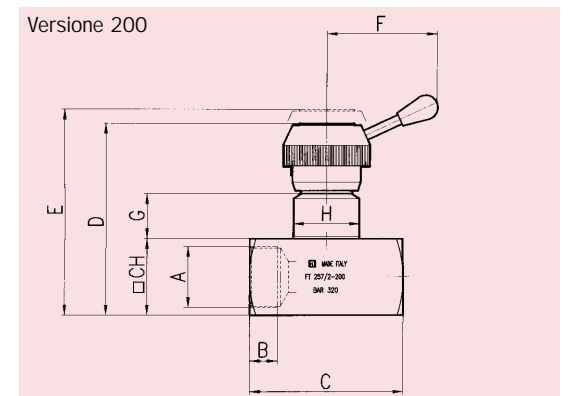
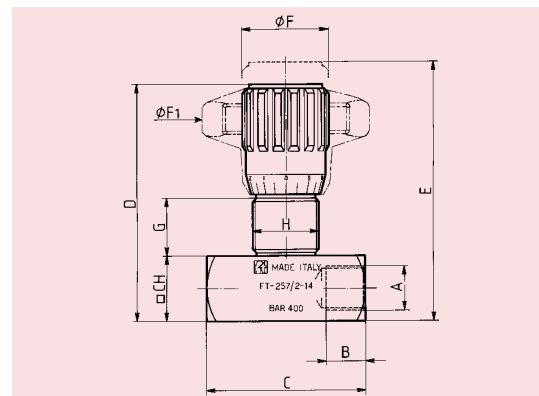

### CODE FT 257/2

Type	A UNI 338	B	C	D	E	F	F1	G	H	CH	Weight kg
18	1/8"G	8.5	38	59	64	22	40	13.5	M17x1	16	0.110
14	1/4"G	12.5	49	71	78	27	50	17	M20x1	20	0.200
38	3/8"G	12.5	59	84	93	33	70	19.5	M25x1.5	25	0.375
12	1/2"G	15.5	68	97	107	38	80	21	M30x1.5	30	0.600
34	3/4"G	17	86	120.5	132.5	47	100	26.5	M40x1.5	40	1.250
100	1"G	20	105	151.5	167.5	58	120	35	M50x1.5	50	2.550
114	1 1/4"G	22	120	156.5	172.5	58	120	35	M50x1.5	55	3.000
112	1 1/2"G	24	134	167	181	58	120	35	M55x2	65	4.217
200	2"G	27	150	188	202	85	/	44	M65x2	75	7.300

Note: Instructions for panel mounting on page 17



HOME



INTRODUCTION



VALVES INDEX



LAST VIEW



PRINT