

# FT 257/5

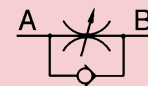

IN LINE NEEDLE  
VALVES CHECK  
VALVES IN CARBON  
STEEL

## Single-acting control needle valves in line

Their function is to control and eventually shut-off the flow in one direction, allowing a free return flow in the opposite direction.

The check valve spring is housed in such a way that it does not close as a pack during opening of the check valve poppet.

Needle adjustments give:

- full shut off (via metal seat);
- accurate control for a wide range of flowrates.

The valve has a graduated adjustment scale below the handle to indicate accurately the valve position.

There is a locking screw in the handle to allow the handle to be fixed. (Preventing accidental adjustment or movement due to vibration).

A panel mounting nut (G) can be supplied on request.  
**Opening pressure is 0.35 bar.**

### On request

- Versions in AISI 316 stainless steel code FT 2257/5
- Viton seals (V)
- NPT threads
- Complete with panel mounting nut (G)
- Handwheel in ABS (mp) - plastic

## MATERIALS

Body	9 s Mn Pb 23 - UNI 5105
Needle	1 C 40 - UNI 8373
Or	Nitrile
Antiextrusion ring	PTFE
Check Valve	38 Ni Cr Mo 4 - UNI - EN 10083
Spring	C 72 UNI 3545
Threaded end-plate	35 S Mn Pb 10 - UNI 5105
Handwheel	GD - Al Si 12 - UNI 5706 aluminium
Handwheel (mp)	ABS - plastic

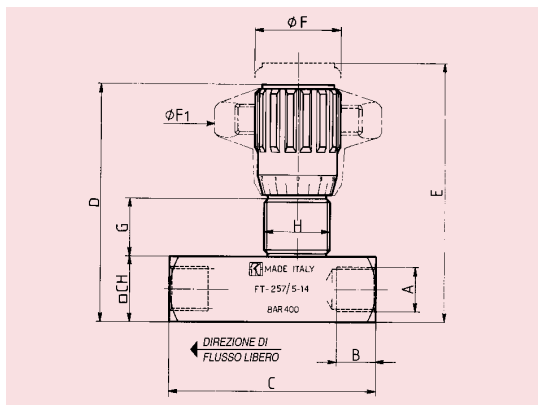

## EXAMPLE FOR ORDERING

CODE  
FT 257/5

### Accessories on request

	Code	Type	Panel ring	Viton seal	Handwheel in plastic
Steel	FT 257/5	18	G	V	mp
Stainl. steel	FT 2257/5	34	G	V	mp

Type	A UNI 338	B	C	D	E	F	F1	G	H	CH	Weight kg
18	1/8"G	8.5	50	59	64	22	40	13.5	M17x1	16	0.130
14	1/4"G	12.5	66	71	78	27	50	17	M20x1	20	0.250
38	3/8"G	12.5	79	84	93	33	70	19.5	M25x1.5	25	0.500
12	1/2"G	15.5	94.5	97	107	38	80	21	M30x1.5	30	0.750
34	3/4"G	17	115	120.5	132.5	47	100	26.5	M40x1.5	40	1.600
100	1"G	20	138.5	151.5	167.5	58	120	35	M50x1.5	50	3.050
114	1 1/4"G	22	157	156.5	172.5	58	120	35	M50x1.5	55	3.750
112	1 1/2"G	24	190	167	181	58	120	35	M55x2	65	5.760
200	2"G	27	228	188	202	85	-	44	M65x2	75	10.000

Note: Instructions for panel mounting on page 17



HOME



INTRODUCTION



VALVES INDEX



LAST VIEW



PRINT

## TECHNICAL DATA

Type	Port section sq. cm	Working pressure bar	Min. Burst. pressure bar	Working temperature °C	Filtration grade μm
18	0.12	400	1600	-20°/+100°	25
14	0.19	400	1600	-20°/+100°	25
38	0.39	400	1600	-20°/+100°	25
12	0.68	400	1600	-20°/+100°	25
34	1.13	400	1600	-20°/+100°	25
100	2.09	320	1300	-20°/+100°	25
114	2.09	320	1300	-20°/+100°	25
112	3.14	320	1300	-20°/+100°	25
200	4.91	320	1300	-20°/+100°	25

Versione 200

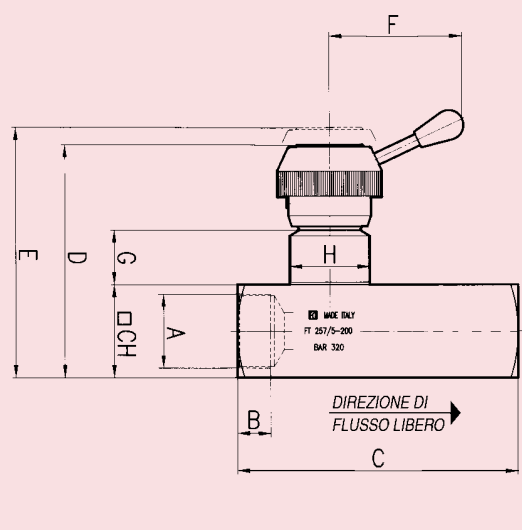

## FLOWRATE CURVES

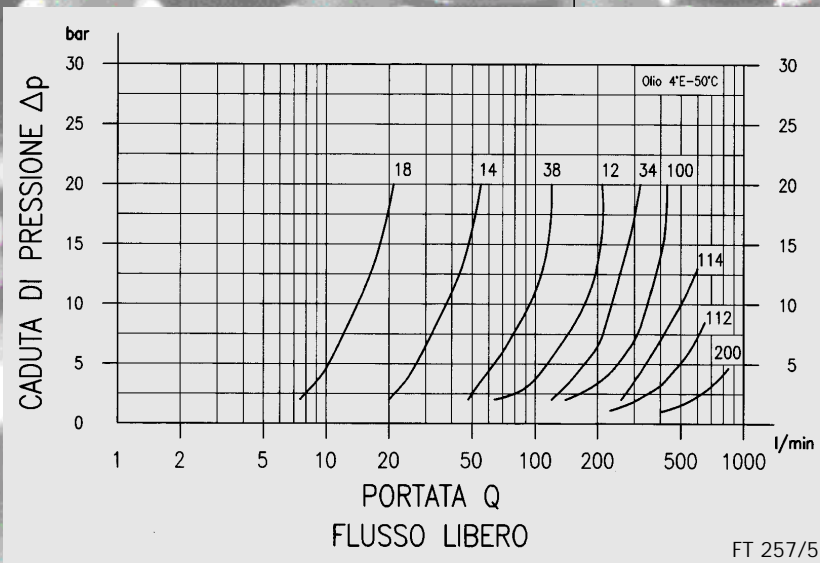

FT 257/5

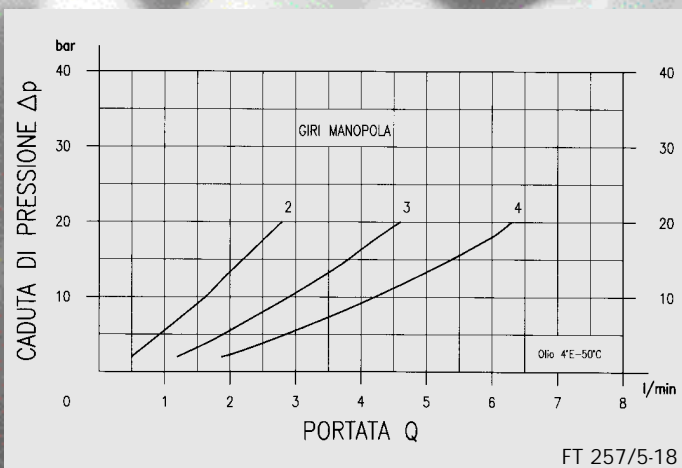

FT 257/5-18

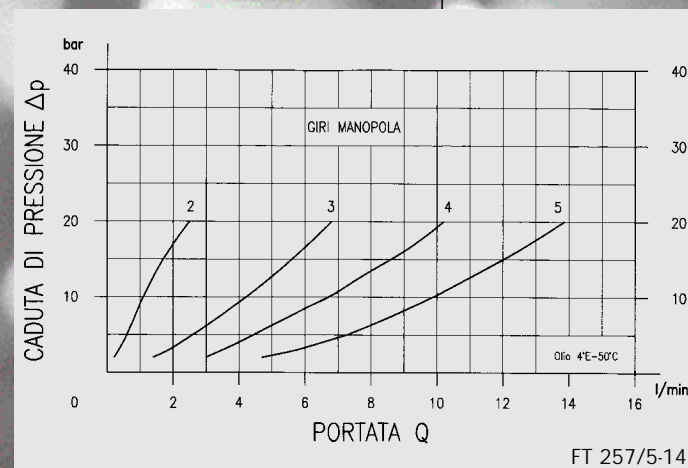

FT 257/5-14



HOME



INTRODUCTION



VALVES INDEX



LAST VIEW



PRINT

# FT 257/5

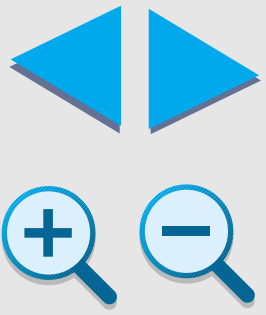
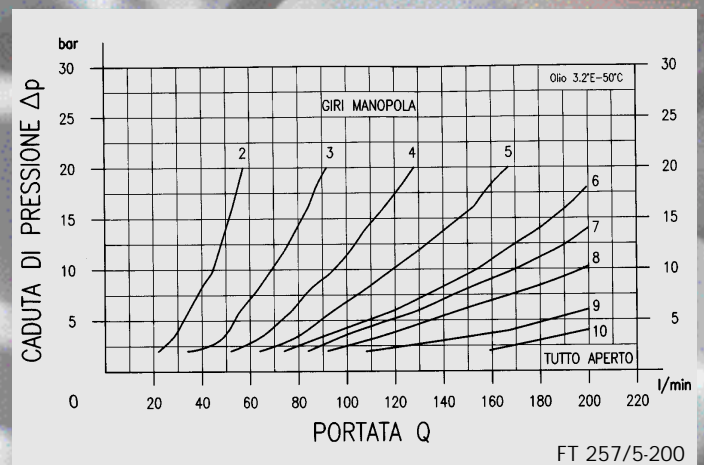
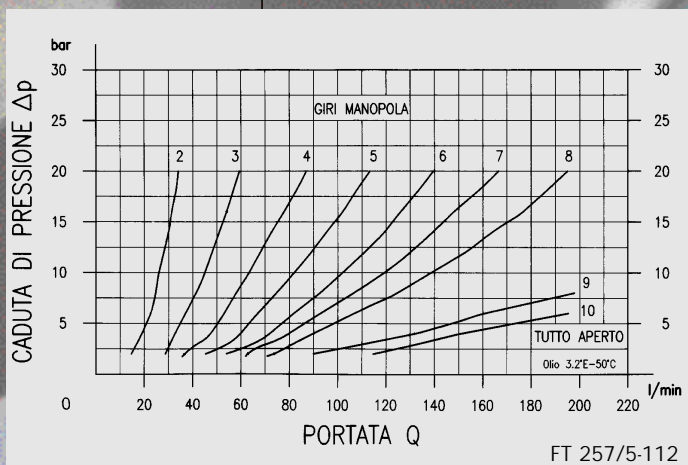
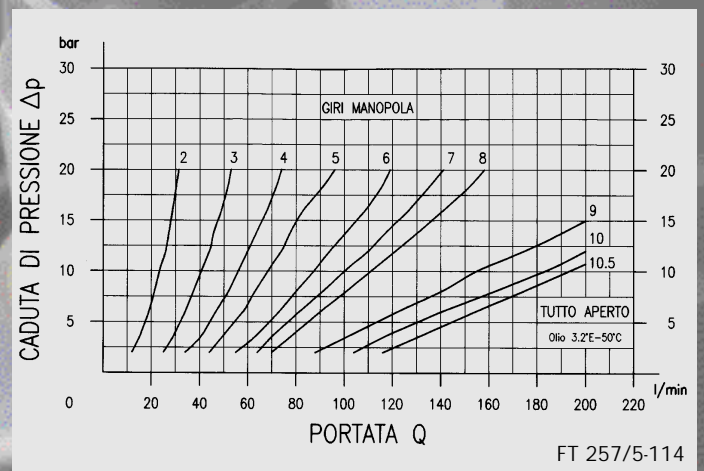
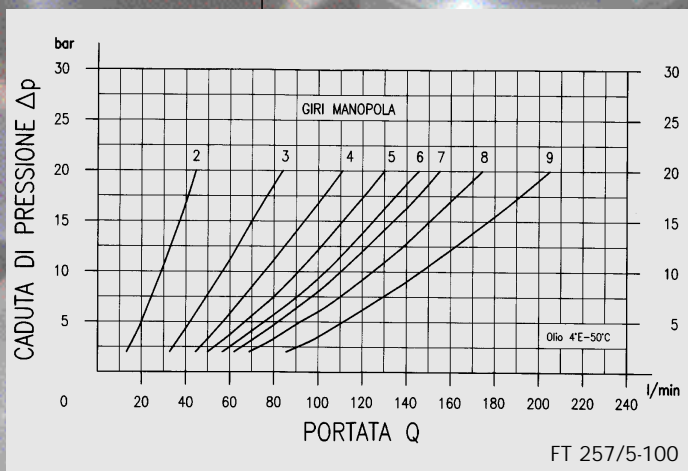
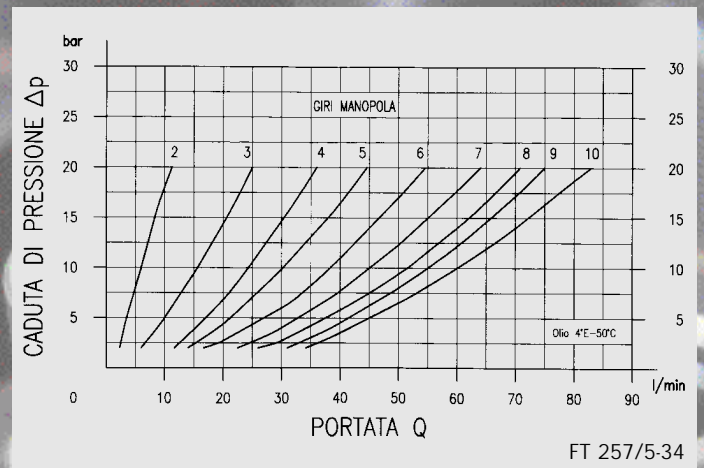
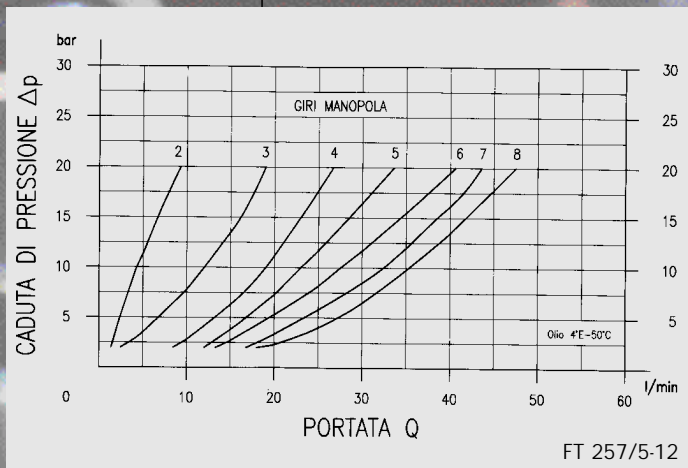
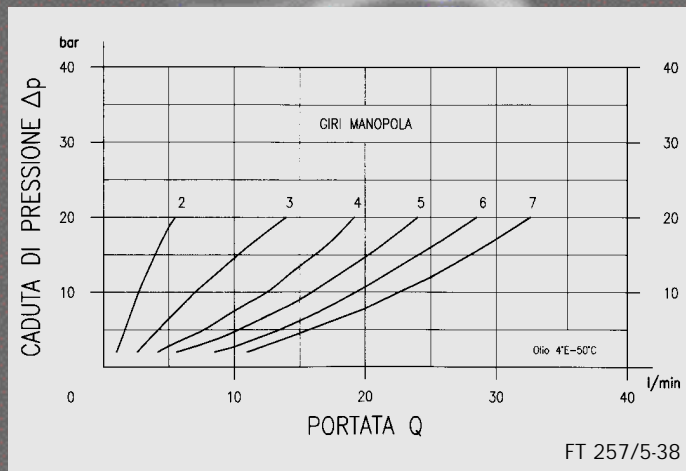

### Montaggio a pannello

- 1° Allentare il grano di pressione (4)
- 2° Togliere il tappo (1)
- 3° Svitare la vite (2)
- 4° Estrarre con forza la manopola (3)
- 5° Introdurre la ghiera KM (9) indicata nella tabella (a richiesta viene fornita con la valvola)

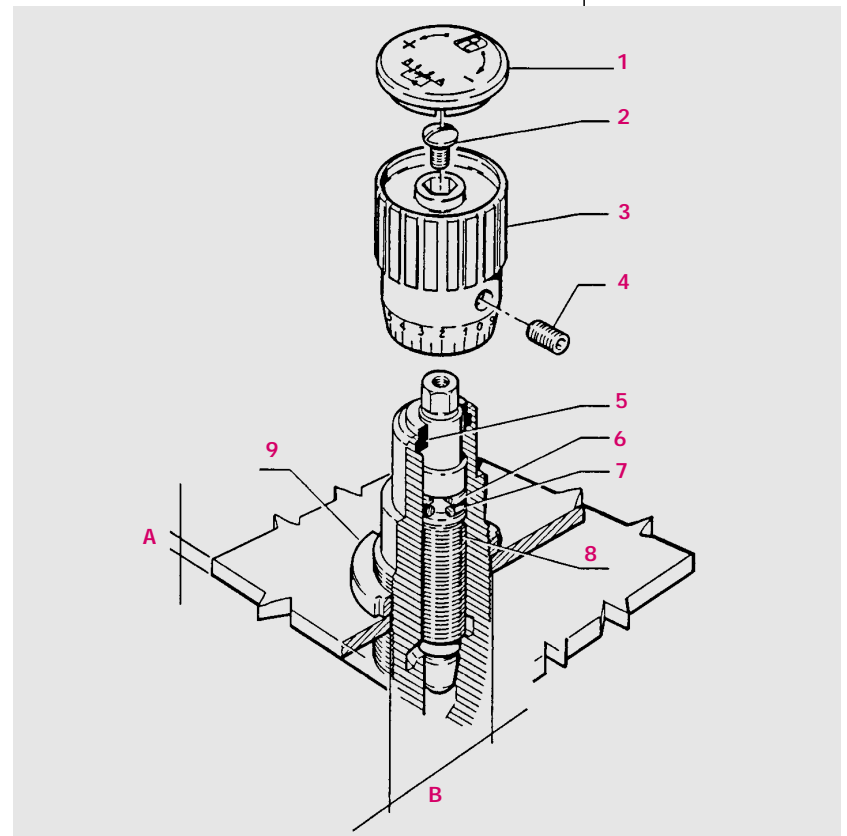

Seal and lock nut spare parts									
Type	18	14	38	12	34	100	114	112	200
(7) OR	2018	2021	108	2043	115	123	123	128	3106
(6) Antiextrusion ring	2018	2021	108	2043	115	123	123	128	3106
(9) Lock nut KM	KM 3 (FT 202/3)	KM 4 (FT 202/4)	KM 5 (FT 202/5)	KM 6 (FT 202/6)	KM 8 (FT 202/8)	KM 10 (FT 202/10)	KM 10 (FT 202/10)	KM 11	KM 13
A max thickness	6	8	10	10	10	10	10	12	12
B bore for panel mount.	18	21	26	31	41	51	51	56	66

