

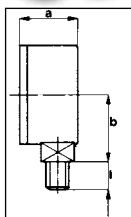

MODELLO RADIALE



BOTTOM MODEL

VERSIONE BASE · Basic version

codice code number	tipo typ	∅	cassa in acciaio casing in steel	glicerina glycerine	trasparente in metacrilato transparent in metacrylate	classe 1,6 class 1,6	peso (grammi) weight (grams)	n.pz per scatola items per carton
M 435 RL	D	40	✓	✓	✓	✓	103	150
M 535 RL	D	50	✓	✓	✓	✓	153	100
M 635 RL	D	63	✓	✓	✓	✓	195	100
M 105 RL	D	100	✓	✓	✓		550	50

OPZIONI · Option

codice code number	tappo di strozzamento throtling plug	classe I class I	saldatura in argento soldered	vite di calibrazione micrometrica micrometric calibration screw	silicone silicone	flangia posteriore rear flange
M 435 RL	✓		✓		✓	
M 535 RL	✓		✓		✓	
M 635 RL	✓		✓	✓	✓	✓
M 105 RL	✓	✓	✓	✓	✓	✓

MODELLO POSTERIORE

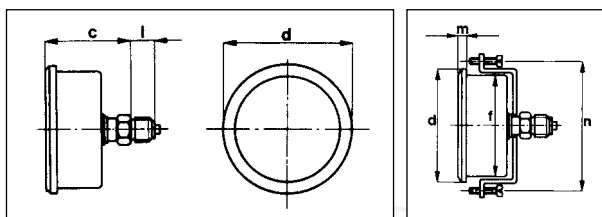

CENTER BACK MODEL

VERSIONE BASE · Basic version

codice code number	tipo typ	∅	cassa in acciaio inossidabile casing in stainless steel	glicerina glycerine	trasparente in metacrilato transparent in metacrylate	classe 1,6 class 1,6	peso (grammi) weight (grams)	n.pz per scatola items per carton
M 438 PBL	F	40	✓	✓	✓	✓	110	150
M 538 PBL	F	50	✓	✓	✓	✓	150	100
M 638 PBL	F	63	✓	✓	✓	✓	215	100
M 108 PBL	F	100	✓	✓	✓		500	25

OPZIONI · Option

codice code number	tappo di strozzamento throtling plug	classe I class I	saldatura in argento soldered	vite di calibrazione micrometrica micrometric calibration screw	silicone silicone	staffa tipo G bracket G
M 438 PBL	✓		✓	✓	✓	
M 538 PBL	✓		✓	✓	✓	
M 638 PBL	✓		✓	✓	✓	✓
M 108 PBL	✓	✓	✓	✓	✓	✓

Pressure and vacuum gauges

Pressure gauges

Pressure gauge DN 63 vertical connection with glycerin (1/4" BSP)

Page: 1/2

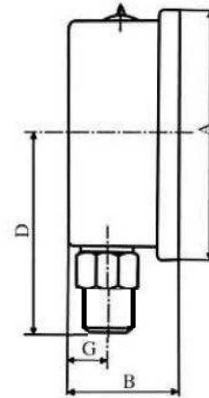
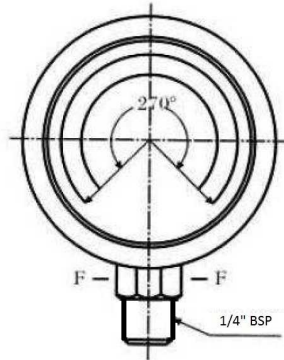

Accuracy: 1,6%

Dimensions: A=68
B=29,8
D=54,5
F=HEX 14
G=9,5

Temperature: from -20 up to +60

Part n°	R1	Scale (bar)
MFI6304001V	1/4" BSP	0-1
MFI63042.5V	1/4" BSP	0-2.5
MFI6304004V	1/4" BSP	0-4
MFI6304006V	1/4" BSP	0-6
MFI6304010V	1/4" BSP	0-10
MFI6304012V	1/4" BSP	0-12
MFI6304016V	1/4" BSP	0-16
MFI6304020V	1/4" BSP	0-20
MFI6304025V	1/4" BSP	0-25
MFI6304040V	1/4" BSP	0-40
MFI6304060V	1/4" BSP	0-60
MFI6304100V	1/4" BSP	0-100
MFI6304160V	1/4" BSP	0-160
MFI6304250V	1/4" BSP	0-250
MFI6304315V	1/4" BSP	0-315
MFI6304400V	1/4" BSP	0-400

Pressure and vacuum gauges

Pressure gauges

Pressure gauge DN 63 vertical connection with glycerin (1/4" BSP)

Page: 2/2

Part n°	R1	Scale (bar)
MFI6304600V	1/4" BSP	0-600
MFI63041000V	1/4" BSP	0-1000

***** Review attached PDF*****
With dual bar/psi scale